

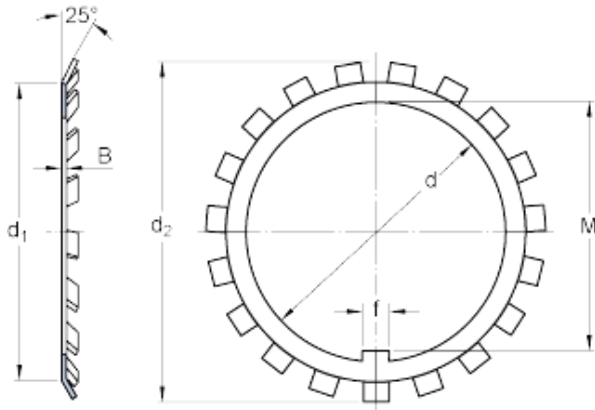

BEARINGS(UK)LTD.



skf MB 4 Lock nuts requiring a keyway, MB(L)
lock washers

Bearing No. MB 4

| | |
|------------------|----------|
| d | 20 mm |
| d ₁ | 26 mm |
| d ₂ | 36 mm |
| B | 1 mm |
| f | 4 mm |
| M | 18.5 mm |
| Mass lock washer | 0.004 kg |

MB 4 Bearing 2D drawings and 3D CAD models