

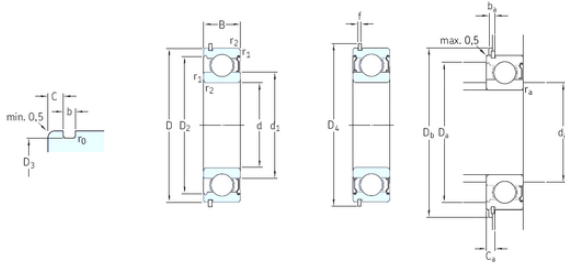

BEARINGS(UK)LTD.



40 mm x 90 mm x 23 mm skf 6308-2ZNR Deep groove ball bearings

Bearing No. 6308-2ZNR

6308-2ZNR Bearing 2D drawings and 3D CAD models

Size	40x90x23 mm
Bore Diameter	40 mm
Outer Diameter	90 mm
Width	23 mm
d	40 mm
D	90 mm
B	23 mm
C	23 mm
b	2,7 mm
d1	56,1 mm
f	2,46 mm
r0 max.	0,6 mm
r1 min.	1,5 mm
r2 min.	1,5 mm
C	3,28 mm
D2	77,7 mm
D3	86,79 mm
D4	96,5 mm
ba min.	5,74 mm
Ca max.	5,74 mm
da min.	3 mm
da max	56 mm
Da max.	81 mm
Db min.	98 mm
ra max.	1,5 mm



BEARINGS(UK)LTD.

Weight	0,65 Kg
Basic dynamic load rating (C)	42,3 kN
Basic static load rating (C0)	24 kN
Fatigue load limit (Pu)	1,02
Reference speed	17000 r/min
Limiting speed	11000 r/min
Calculation factor (f0)	13
d ₁	56.11 mm
D ₂	77.7 mm
D ₃	86.79 mm
D ₄	96.5 mm
r ₀ max.	0.6 mm
r _{1,2} min.	1.5 mm
d _a min.	49 mm
d _a max.	56 mm
D _a max.	81 mm
D _b min.	98 mm
b _a min.	3 mm
C _a max.	5.74 mm
r _a max.	1.5 mm
Basic dynamic load rating C	42.3 kN
Basic static load rating C ₀	24 kN
Fatigue load limit P _u	1.02 kN
Calculation factor k _r	0.03
Calculation factor f ₀	13.2
Mass bearing	0.64 kg
Snap ring	SP 90