

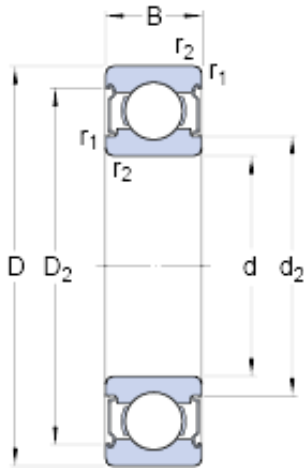

BEARINGS(UK)LTD.



W 6210-2Z Bearing 2D drawings and 3D CAD models

50 mm x 90 mm x 20 mm skf W 6210-2Z Deep groove ball bearings

Bearing No. W 6210-2Z

Size	90x50x20 mm
Bore Diameter	90 mm
Outer Diameter	50 mm
Width	20 mm
d	50 mm
D	90 mm
B	20 mm
d ₂	60 mm
D ₂	82.15 mm
r _{1,2} - min.	1.1 mm
d _a - min.	56.5 mm
d _a - max.	60 mm
D _a - max.	83.5 mm
r _a - max.	1 mm
Basic dynamic load rating - C	30.2 kN
Basic static load rating - C ₀	23.2 kN
Fatigue load limit - P _u	0.98 kN
Reference speed	17000 r/min
Limiting speed	8500 r/min
Calculation factor - k _r	0.03
Calculation factor - f ₀	14.4
Category	Single Row Ball Bearings
Inventory	0.0
Manufacturer Name	SKF



BEARINGS(UK)LTD.

Minimum Buy Quantity	N/A
Weight / Kilogram	0
EAN	7316571866864
Product Group	B00308
Enclosure	2 Metal Shields
Precision Class	ABEC 1 ISO P0
Maximum Capacity / Filling Slot	No
Rolling Element	Ball Bearing
Snap Ring	No
Internal Special Features	No
Cage Material	Stainless Steel
Internal Clearance	C0-Medium
Inch - Metric	Metric
Long Description	50MM Bore; 90MM Outside Diameter; 20MM Outer Race Width; 2 Metal Shields; Ball Bearing; ABEC 1 ISO P0; No Filling Slot; No Snap Ring; No Internal Special Features; C0-Medium Internal Clearance; Stai
Other Features	Deep Groove
Category	Single Row Ball Bearing
UNSPSC	31171504
Harmonized Tariff Code	8482.10.50.68
Noun	Bearing
Keyword String	Ball
Manufacturer URL	http://www.skf.com
Manufacturer Item Number	W 6210-2Z
Weight / LBS	1.033
Outside Diameter	3.543 Inch 90 Millimeter
Inner Race Width	0 Inch 0 Millimeter
Outer Race Width	0.787 Inch 20 Millimeter



BEARINGS(UK)LTD.

Bore	1.969 Inch 50 Millimeter
d_2	60 mm
D_2	82.15 mm
$r_{1,2}$ min.	1.1 mm
d_a min.	55 mm
d_a max.	59.5 mm
D_a max.	83.5 mm
r_a max.	1 mm
Basic dynamic load rating C	30.2 kN
Basic static load rating C_0	23.2 kN
Fatigue load limit P_u	0.98 kN
Calculation factor k_r	0.03
Calculation factor f_0	14.4
Mass bearing	0.45 kg